

CAMPUS MOVE-IN INSTRUCTIONS

Directions for Unloading and Parking Vehicles

Due to premium parking around the residence halls, residents and their families are requested to unload quickly (15 minute time limit) and move vehicles to designated parking areas. You will only be allowed to move in during your specified time range, which is noted on your assignment letter. Once on campus, Campus Safety Officers will be directing traffic and will be happy to provide assistance.

Students living on West Campus should use the parking instructions below.

Penn/Beard Complex Residents (see Red Route on Map)

Beard, Codorus, Evergreen, Laurel, Penn, Pershing, Springettsbury, Susquehanna, Willow

FROM BALTIMORE, MARYLAND:

Heading North on I-83, take exit 15 (S George St). Proceed to the fourth traffic light and make a left onto Springettsbury Avenue. Then proceed to the fourth stop sign and take another left onto Newberry Street.

FROM HARRISBURG, PENNSYLVANIA:

Heading South on I-83, take exit 15 (S George St). Turn left onto Springettsbury Avenue and proceed through the first light (George St). Make a left onto Newberry Street.

Manor Complex and Tyler Run Residents (See Blue Route on Map)

East, North, Northeast, South, West, Tyler Run I, II, III

FROM BALTIMORE, MARYLAND or HARRISBURG, PENNSYLVANIA:

On I-83 take exit 15 (S George St). Stay in left lane. At the third traffic light, turn left onto Country Club Road. The College entrance is a short distance on the right. Once on campus, bear right at the "Y" and proceed to the stop sign; the Manor Complex will be directly in front of you.

Northside Commons (See Green Route on Map)

Northside Commons

FROM BALTIMORE, MARYLAND:

On I-83 take exit 15 (S George St). Proceed to the fifth traffic light and make a left onto West Jackson Street. Then proceed past five stop signs to the entrance to Northside Commons on the right hand side.

West Campus (See Orange Route on Map)

Brockie Commons, Country Club Manor, Little Run Lodge, Richland, Spring Garden

FROM BALTIMORE, MARYLAND or HARRISBURG, PENNSYLVANIA:

On I-83 take exit 15 (S George St). Stay in left lane. At the third traffic light, turn left onto Country Club Road. Continue past the entrance to the main campus of the College. Turn right onto Reade Avenue.

Parking will be monitored around the West Campus residence halls during the move-in weekend. Students will only be able to park around those complexes for unload purposes (15 minute time limit). Once vehicles are unloaded, please move them to the West Campus parking lot located just north of Richland Hall, beyond York College Drive.

****NEW STUDENTS – LOOK FOR HELP FROM THE YCP MOVE-IN TEAM ON FRIDAY****
!!PLEASE DO NOT LEAVE VEHICLES UNATTENDED!!

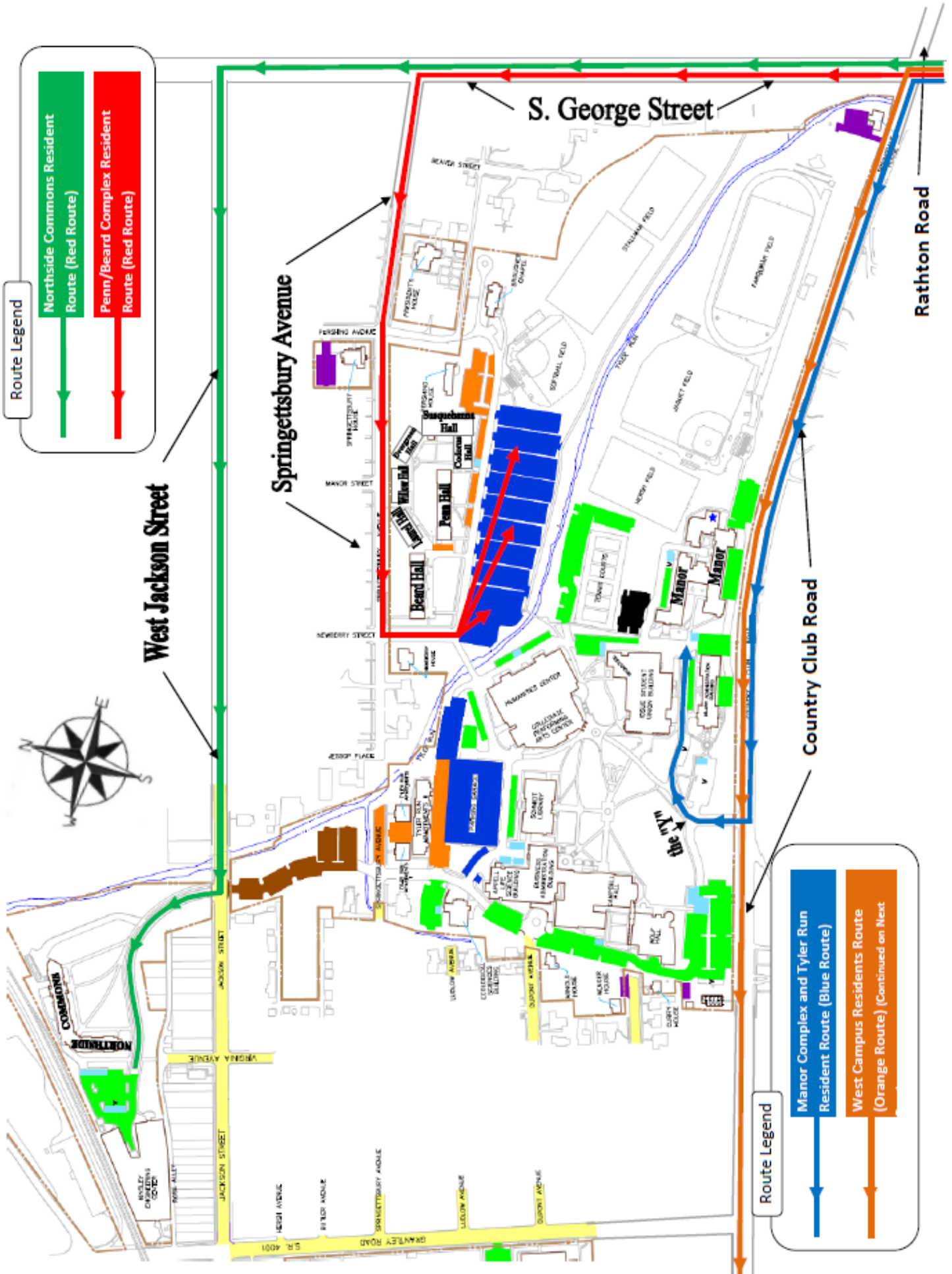

Route Legend

- Northside Commons Resident Route (Red Route)
- Penn/Beard Complex Resident Route (Red Route)

Route Legend

- Manor Complex and Tyler Run Resident Route (Blue Route)
- West Campus Residents Route (Orange Route) (Continued on Next)

West Jackson Street

Springettsbury Avenue

S. George Street

Rathton Road

Country Club Road

Northside Commons Resident Route (Red Route)

Penn/Beard Complex Resident Route (Red Route)

Manor Complex and Tyler Run Resident Route (Blue Route)

West Campus Residents Route (Orange Route) (Continued on Next)

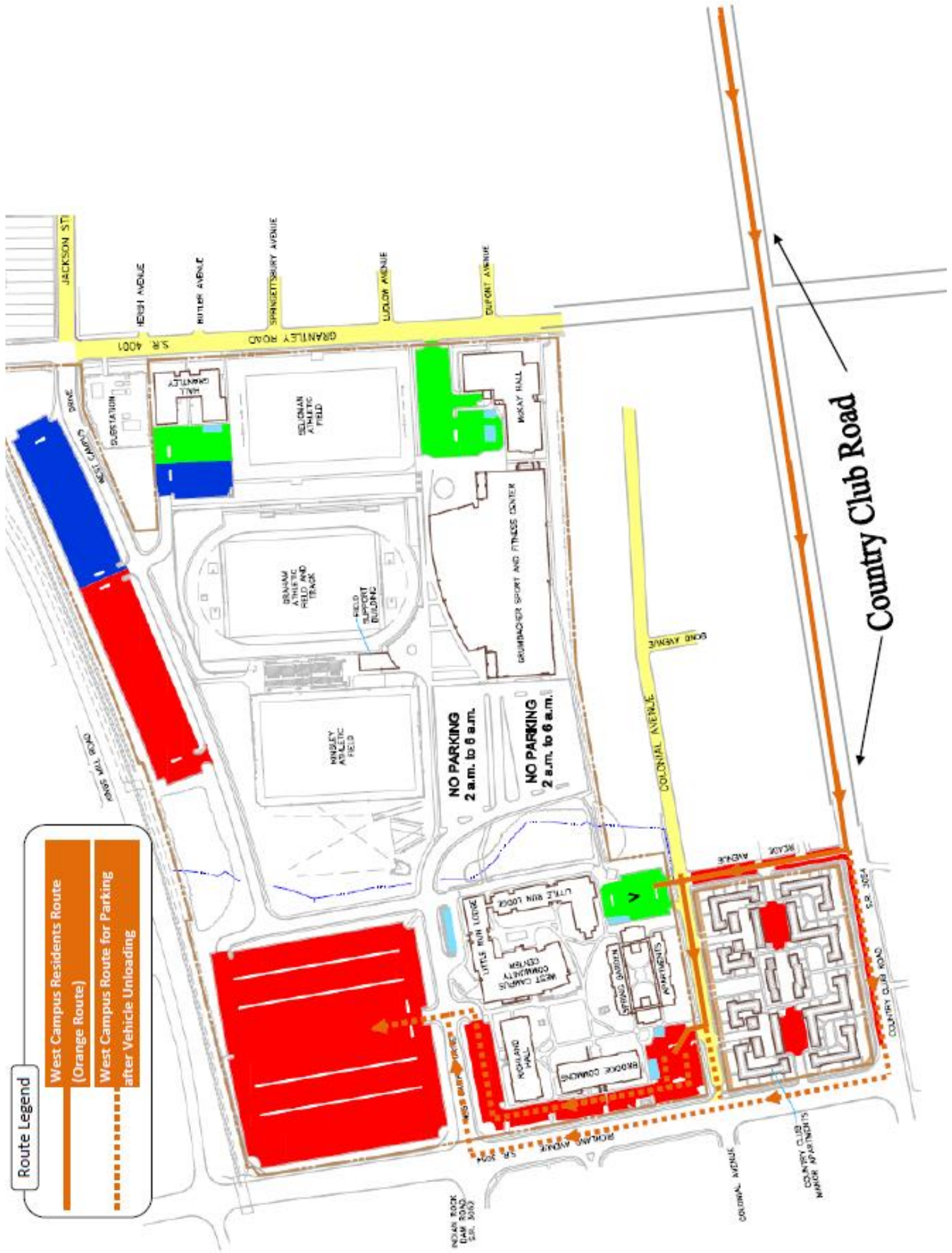

Route Legend

- West Campus Residents Route (Orange Route)
- West Campus Route for Parking after Vehicle Unloading

Country Club Road

NO PARKING
2 a.m. to 6 a.m.

NO PARKING
2 a.m. to 6 a.m.

JACKSON ST

HERSH AVENUE

RUTHER AVENUE

SPRINGETTSHURY AVENUE

LUDLOW AVENUE

DUFORT AVENUE

GRANLLEY ROAD S.R. 4001

WEST CAMPUS DRIVE

WEST CAMPUS DRIVE

COLONIAL AVENUE

REAR AVENUE

S.R. 3024

COUNTRY CLUB ROAD

NOVAH ROCK DR. S.R. 3002

PROVANS AVENUE S.R. 3004

COLONIAL AVENUE

COUNTRY CLUB MARKER APARTMENTS

GRANLLEY HALL

SELONAN ATHLETIC FIELD

MURRAY HALL

BRANHAM ATHLETIC FIELD AND TRACK

FIELD SUPPORT BUILDING

GRUMBACHER SPORT AND FITNESS CENTER

WINDLEY ATHLETIC FIELD

LITTLE RUN LODGE

LITTLE RUN LODGE

WEST CAMPUS COMMUNITY CENTER

SPRING GARDEN APARTMENTS

MOULAND HALL

BROOKSIDE COMMONS

PROVANS AVENUE